

Barbie™

**Blossom Phone™
Caller ID * Telephone**



OWNER'S MANUAL

BAR550

(*Requires a subscription to the Caller ID service from your local telephone company.)
Barbie and associated trademarks and trade dress are owned by, and used under license from, Mattel, Inc. ©2007 Mattel, Inc. All Rights Reserved.

SAFETY PRECAUTIONS



CAUTION

**RISK OF ELECTRIC SHOCK
DO NOT OPEN**



CAUTION: TO REDUCE THE RISK OF ELECTRIC SHOCK, DO NOT REMOVE COVER (OR BACK). NO USER-SERVICEABLE PARTS INSIDE. REFER SERVICING TO QUALIFIED SERVICE PERSONNEL.



DANGEROUS VOLTAGE:

The lightning flash with arrowhead symbol within an equilateral triangle is intended to alert the user to the presence of uninsulated dangerous voltage within the product's enclosure that may be of sufficient magnitude to constitute a risk of electric shock to persons.



ATTENTION:

The exclamation point within an equilateral triangle is intended to alert the user to the presence of important operating and maintenance (servicing) instructions in the literature accompanying the appliance.

CAUTION-ELECTRICALLY OPERATED PRODUCT:

Not recommended for children under 5 years of age. As with all electric products, precautions should be observed during handling and use to prevent electric shock.

TO PREVENT FIRE OR SHOCK HAZARD, DO NOT USE THIS PLUG WITH AN EXTENSION CORD, RECEPTACLE OR OTHER OUTLET UNLESS THE BLADES CAN BE FULLY INSERTED TO PREVENT BLADE EXPOSURE. TO PREVENT FIRE OR SHOCK HAZARD, DO NOT EXPOSE THIS APPLIANCE TO RAIN OR MOISTURE.

1. Read and understand all instructions.
2. Follow all warnings and instructions marked on this product.
3. Unplug this product from the wall telephone jack and power outlet before cleaning. Do not use liquid cleaners or aerosol cleaners. Use a damp cloth for cleaning.
4. Do not use this product near water—for example: near a bathtub, washbowl, kitchen sink or laundry tub; in a wet basement; or near a swimming pool.
5. Do not place this product on an unstable cart, stand, tripod, bracket or table. This product may fall, causing serious injury and serious damage to the product.
6. Slots and openings in the cabinet and in the back or bottom are provided for ventilation and to ensure reliable operation of this product and to protect it from overheating. These openings must not be blocked or covered. The openings should never be blocked by placing the product on a bed, sofa, rug or other similar surface. This product should never be placed near or over a radiator or heat source. This product should not be placed in an enclosed environment unless proper ventilation is provided.
7. This product should be operated only from the type of power source indicated on the marking label. If you are not sure of the type of power supply to your home, consult your dealer or local power company.

SAFETY PRECAUTIONS

8. Do not allow anything to rest on the power cord. Do not locate this product where the cord will be abused by persons walking on it. Do not attach power cord to building surfaces.
9. Do not overload wall outlets and extension cords as this can result in the risk of fire or electric shock.
10. Never push objects of any kind into this product through openings as they may touch dangerous voltage points or short out parts that could result in fire or electric shock. Never spill or spray any type of liquid on this product.
11. To reduce the risk of electric shock, do not disassemble this product, but take it to a qualified serviceman when some service or repair work is required. Opening or removing covers may expose you to dangerous voltages or other risks. Incorrect reassembly can cause electric shock when the appliance is subsequently used.
12. Unplug this product from the wall outlet and refer servicing to qualified service personnel under the following conditions:
 - a. When the power-supply cord or plug is damaged or frayed.
 - b. If this product has been exposed to rain or water.
 - c. If this product does not operate normally by following the operating instructions. Adjust only those controls that are covered by the operating instructions, as an adjustment of other controls may result in damage and will often require extensive work by a qualified technician to restore the product to its normal operation.
 - d. If this product has been dropped or the cabinet has been damaged.
 - e. If the product exhibits a distinct change in performance.
13. Avoid using a telephone (other than a cordless type) during an electrical storm. There may be a remote risk of electric shock from lightning.
14. Do not use the telephone to report a gas leak in the vicinity of the leak.
15. Never install telephone wiring during a lightning storm.
16. Never install telephone jacks in wet locations unless the jack is specifically designed for wet locations.
17. Never touch uninsulated telephone wires or terminals unless the telephone line has been disconnected at the network interface.
18. Use caution when installing or modifying telephone lines.
19. Use only the power cord and batteries indicated in this manual. Do not dispose of batteries in a fire. They may explode. Check with local codes for possible special disposal instructions.
20. **CAUTION: RISK OF EXPLOSION IF BATTERY IS REPLACED BY AN INCORRECT TYPE. DISPOSE OF USED BATTERIES ACCORDING TO THE INSTRUCTIONS.**

SAFETY PRECAUTIONS

CHANGES IN TELEPHONE COMPANY EQUIPMENT

The telephone company may make changes in its communications facilities, equipment, operations or procedures, where such action is reasonably required and proper in its business. Should any such changes render the customer's external equipment incompatible with the telephone company facilities, the customer shall be given adequate notice to make modifications to maintain uninterrupted service.

GENERAL

The FCC prohibits customer-provided terminal equipment to be connected to party lines or to be used in conjunction with a coin telephone service.

INSTALLATION

The device is equipped with a USOC RJ11C standard miniature modular jack and is designed to plug directly into a modular jack.

CONSUMER INFORMATION

This equipment complies with Part 68 of the FCC rules and the requirements adopted by the ACTA. On the bottom of this equipment is a label that contains, among other information, a product identifier of US: HU4TE12BBAR550. If requested, this number must be provided to the telephone company. The applicable jacks (i.e. RJ11C) for this equipment are provided in the packaging with each piece of approved equipment. The jacks are certified by Universal Service Order Codes (USOC). A plug and jack used to connect this equipment to the premises wiring and telephone network must comply with the applicable FCC Part 68 rules and requirements adopted by the ACTA. A compliant telephone cord and modular plug are provided with this product. They are designed to be connected to a compatible modular jack that is also compliant. See installation instructions for details.

The REN is used to determine the number of devices that may be connected to a telephone line. Excessive RENs on a telephone line may result in the devices not ringing in response to an incoming call. In most but not all areas, the sum of RENs should not exceed five (5.0). To be certain of the number of devices that may be connected to a line, as determined by the total RENs, contact the local telephone company. [For products approved after July 23, 2001, the REN for this product is part of the product identifier that has the format US:AAAEQ##TXXXX. The digits represented by ## are the

SAFETY PRECAUTIONS

REN without a decimal point (e.g., 03 is a REN of 0.3). For earlier products, the REN is separately shown on the label.]

If this equipment causes harm to the telephone network, the telephone company will notify you in advance that temporary discontinuance of service may be required. But if advance notice isn't practical, the telephone company will notify the customer as soon as possible. Also, you will be advised of your right to file a complaint with the FCC if you believe it is necessary. The telephone company may make changes in its facilities, equipment, operations or procedures that could affect the operation of the equipment. If this happens the telephone company will provide advance notice in order for you to make necessary modifications to maintain uninterrupted service. If you experience trouble with this equipment, disconnect it from the network until the problem has been corrected or until you are sure that the equipment is not malfunctioning.

Please follow instructions for repairing if any (e.g. battery replacement section); otherwise do not alter or repair any parts of device except specified. Connection to party line service is subject to state tariffs. Contact the state public utility commission, public service commission or corporation commission for information. This equipment is hearing aid compatible.

NOTICE: If your home has specially wired alarm equipment connected to the telephone line, ensure the installation of this equipment does not disable your alarm equipment. If you have questions about what will disable alarm equipment, consult your telephone company or a qualified installer.

WARNING: Changes or modifications to this unit not expressly approved by the party responsible for compliance could void the user's authority to operate the equipment.

SAFETY PRECAUTIONS

FCC INFORMATION:

This equipment has been tested and found to comply with the limits for a Class B digital device, pursuant to Part 15 of the FCC Rules. These limits are designed to provide reasonable protection against harmful interference in a residential installation. This equipment generates, uses and can radiate radio frequency energy and, if not installed and used in accordance with the instructions, may cause harmful interference to radio communications. However, there is no guarantee that interference will not occur in a particular installation. If this equipment does cause harmful interference to radio or television reception, which can be determined by turning the equipment off and on, the user is encouraged to try to correct the interference by one or more of the following measures:

- Reorient or relocate the receiving antenna.
- Increase the separation between the equipment and receiver.
- Connect the equipment into an outlet on a circuit different from that to which the receiver is connected.
- Consult the dealer or an experienced radio/TV technician for help.

FCC WARNING:

This equipment may generate or use radio frequency energy. Changes or modifications to this equipment may cause harmful interference unless the modifications are expressly approved in the instruction manual. The user could lose the authority to operate this equipment if an unauthorized change or modification is made.

WELCOME

Emerson Radio Corp. has produced this product under license from Mattel. We have taken great care to make sure your unit was in perfect working order when it left our factory.

It has been designed to give you many years of enjoyment and trouble-free operation. Read this manual before operating this unit to become familiar with its features. In the event you require technical assistance, please contact the Emerson Radio Customer Service hotline at 1-800-898-9020. Retain this manual for future reference.



WARNING

Choking Hazard—Small Parts and Packaging Materials. Not for children under 5 years.

- All materials for fastening or packing purposes are not part of the unit and should be discarded for children's safety.
- Please keep all information for future reference.
- This is not a toy.

NOTES:

- Please avoid using this unit in places of high temperature or humidity over prolonged periods of time as damage may occur.
- Exposure to direct sunlight in places such as car interiors may cause the unit to become warped and/or lead to malfunctioning.
- Avoid using or storing this unit in dusty or sandy locations.

LOCATION OF CONTROLS

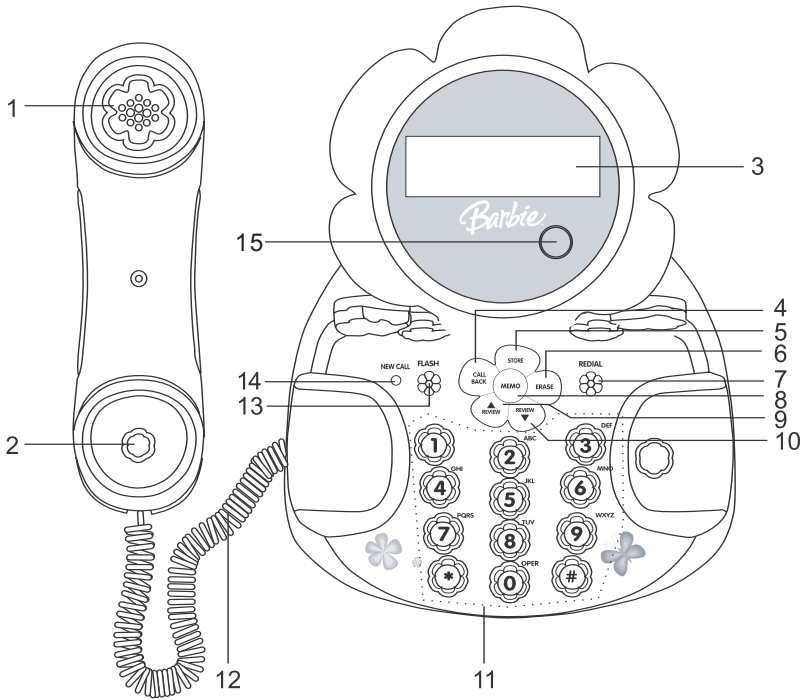

- | | |
|--------------------------|---------------------------------|
| 1. Receiver | 11. Key Buttons (0-9,*,#) |
| 2. Transmitter | 12. Handset Cord |
| 3. Display | 13. FLASH Button |
| 4. CALL BACK Button | 14. NEW CALL Indicator |
| 5. STORE Button | 15. GEMSTONE FUN (Sound) Button |
| 6. ERASE Button | |
| 7. REDIAL Button | |
| 8. MEMO Button | |
| 9. REVIEW UP ▲ Button | |
| 10. REVIEW DOWN ▼ Button | |

LOCATION OF CONTROLS (CONTINUED)

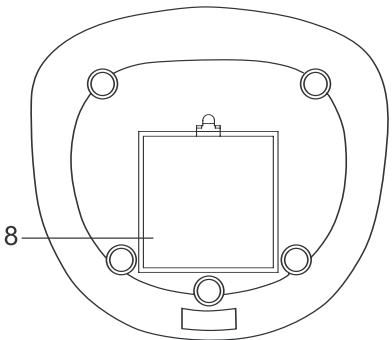
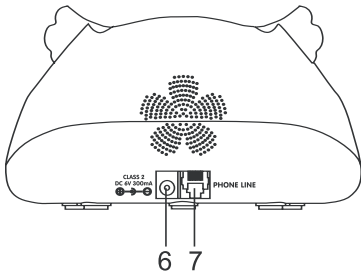
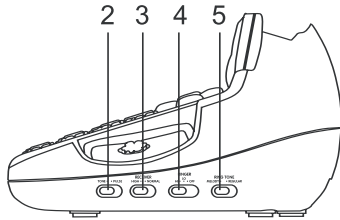
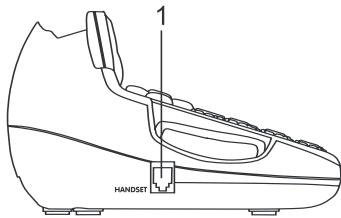

1. Handset Jack
2. TONE/PULSE Switch
3. RECEIVER (HIGH/NORMAL) Volume Switch
4. HI (High)/LO (Low)/OFF Ringer Switch
5. MELODY/REGULAR Ring Tone Switch
6. DC IN Jack
7. LINE In Jack
8. Battery Compartment

INSTALLATION

UNPACKING:

When unpacking, make sure the following are included:

- BAR550 Telephone
- Handset Cord
- Line Cord

If any of these items are missing or damaged, contact customer service. Keep the packaging to transport the telephone.

TO INSTALL BATTERIES

When the batteries become weak, the battery icon () will appear in the display. Replace as described below. You must replace the batteries within two minutes, or the caller ID and memories will be lost.

Insert four (4) "AA" size (UM-3) batteries (not included) in this unit to use the Caller ID and telephone functions as follows:

1. Open the battery door by pulling back on the latch. Use a ball point pen, pencil, paper clip or similar object to release the latch.
2. Insert four (4) "AA" size (UM-3) alkaline batteries (not included).
3. Snap the battery door back into place.

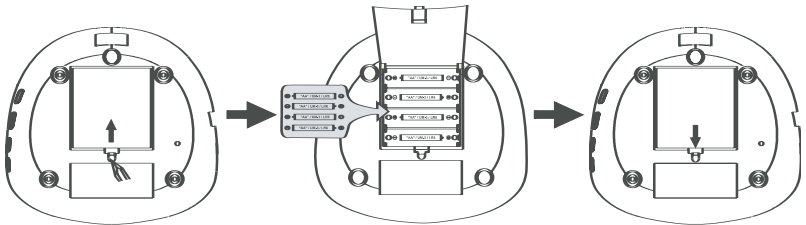

CAUTION:

Disconnect the telephone line from the equipment before replacing batteries.

BATTERY PRECAUTIONS

- * Replacement of batteries must be done by an adult.
- * Do not mix old and new batteries.
- * Do not mix alkaline, standard (carbon-zinc) or rechargeable (nickel-cadmium) batteries.
- * The supply terminals are not to be short-circuited.
- * Non-rechargeable batteries are not to be recharged.
- * Exhausted batteries are to be removed.
- * Only batteries of the equivalent type are to be used.
- * Batteries are to be inserted with the correct polarity.
- * Dispose of batteries properly.
- * Do not dispose of batteries in fire; batteries may explode or leak.

INSTALLATION (CONTINUED)

AC OPERATION

To operate the unit using AC power, connect an AC adapter to the DC jack on the back of the base and to a wall outlet having 120V, 60Hz AC only. The batteries will work as battery back-up in the event of power failure and will keep all of the functions without interruption. Make sure to only use the supplied adapter, 6V 300mA with positive center (⊖⊕).

This unit can be used on a desk, or other level surface away from excessive heat or direct sunlight.

1. Set the HI/LO/OFF Ringer switch to HI or LO to have the ringer sound when receiving a phone call.
2. Set the TONE/PULSE switch to TONE or PULSE to match the service provided on your telephone line. If you are not sure of your service, please contact your telephone company.
3. **DO NOT CONNECT TO THE TELEPHONE LINE UNTIL CALLER ID SETUP IS COMPLETED.** Connect the coiled cord to the handset and base. Connect the line cord into the jack on the back of the base.

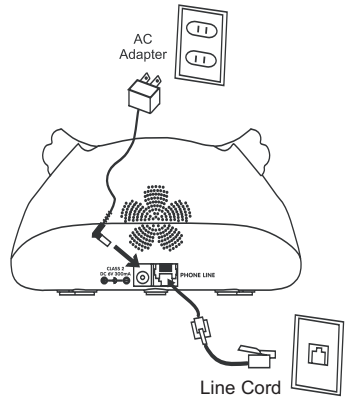

SET-UP INSTRUCTIONS

DO NOT CONNECT the line cord to the wall outlet until the caller ID setup has been completed. Set the language, contrast, time and date as follows:

TO RESET, press and hold both the ▼/▲ buttons simultaneously for four seconds until "ENTER LANGUAGE" appears.

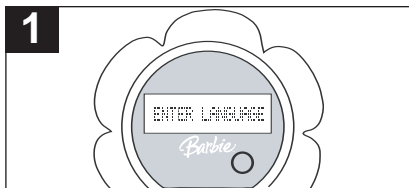

Press and hold the ▼ and ▲ button simultaneously for four seconds until "ENTER LANGUAGE" appears, followed by ENG (English), ESP (Spanish), FRA (French) for 20 seconds.

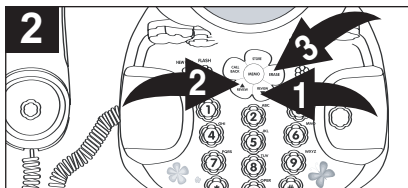

SELECT THE LANGUAGE:

Press the ▼ ① or ▲ ② button to select ENG (English), ESP (Spanish) or FRA (French). Press the ERASE button ③ to confirm.

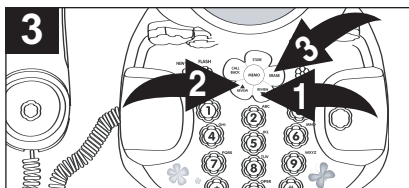

SELECT THE CONTRAST:

Press the ▼ ① or ▲ ② button to select one of the five contrast levels (default is three). Press the ERASE button ③ to confirm.

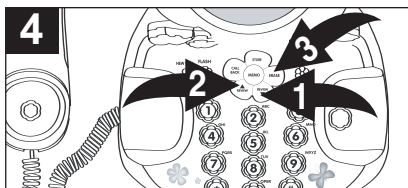

SELECT THE TIME AND DATE:

Press the ▼ ① or ▲ ② button to select the present hour. Press the ERASE button ③ to confirm. Repeat this step to set the minutes.

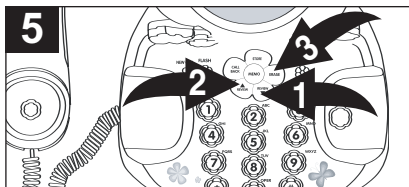

Press the ▼ ① or ▲ ② button to select the present month. Press the ERASE button ③ to confirm. Repeat this step to set the day. The settings are now complete.

OPERATION

PLACING A CALL

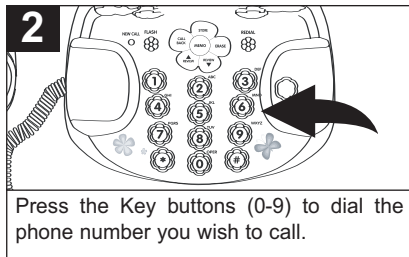
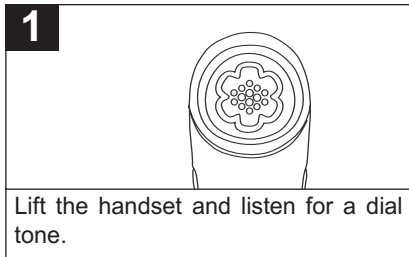

RECEIVING A CALL

Up to 64 incoming calls are saved in the Caller ID log.

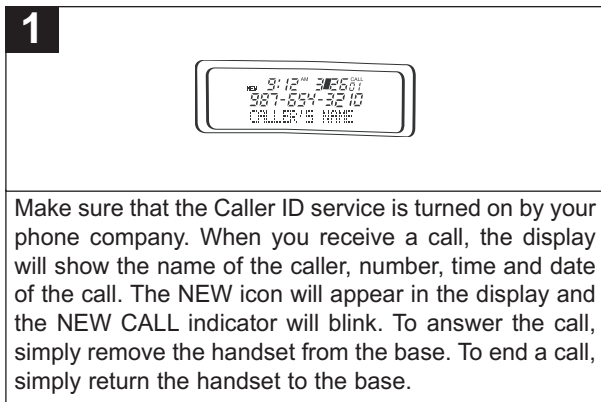

NOTES:

- If a call is received from an area which does not provide Caller ID service, the display will show "UNAVAILABLE".
- If a call is received from a caller that has blocked his/her information, the display will show, "PRIVATE CALL".
- If you subscribe to Caller ID, the time and date are automatically set when the first call is received.
- Calls picked up on the first ring will not be logged in the Caller ID log.
- If there are new calls, the NEW icon will appear in the display and NEW CALL indicator will blink.
- If a call was received incorrectly or only part of the data was received, the display will show "LINE ERROR".

OPERATION (CONTINUED)

RINGER TONE SWITCH

Your phone features an optional Barbie™ melody ring tone; the flashing flower petals indicate incoming calls.

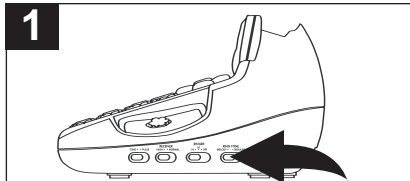

Slide the RINGER TONE switch to the REGULAR position for the standard ring. Slide to the MELODY position to hear the Barbie melody ring; the flashing flower petals indicate incoming calls.

HI/LO/OFF RINGER SWITCH

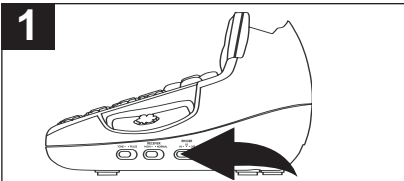

Slide the HI/LO/OFF Ringer switch to the HI or LO position to turn the ringer on. Slide the HI/LO/OFF Ringer switch to the OFF position to turn the ringer off.

TONE/PULSE SWITCH

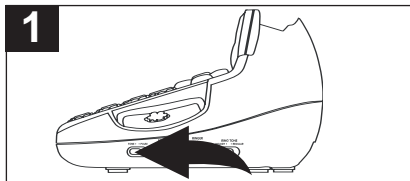

Slide the TONE/PULSE switch to TONE or PULSE position to match the service provided on your telephone line. If you are not sure of your service, please contact your telephone company.

RECEIVER VOLUME SWITCH

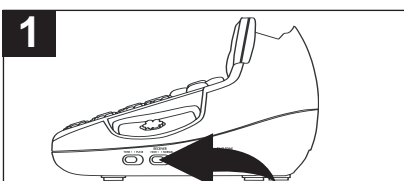

To increase/decrease the handset's volume, slide the RECEIVER Volume switch to the HIGH or NORMAL position.

REDIAL BUTTON

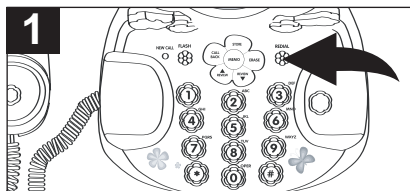

Press the REDIAL button to automatically redial the last number dialed.

NOTE: Please note that only the last number you called on this handset can be stored in the Redial memory.

FLASH BUTTON

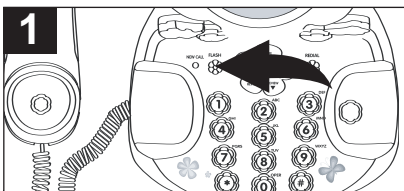

Press the FLASH button to hang up the phone without having to return it to the base. This is useful for using the phone with the Call Waiting feature.

OPERATION (CONTINUED)

USING THE TONE BUTTON

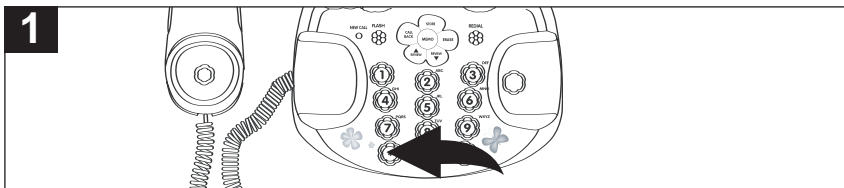

1

If you are in the Pulse dialing mode you may still take advantage of touch-tone services after dialing to respond to touch-tone prompts. To do this, press the */TONE button to temporarily change the dialing mode from Pulse to Tone after dialing in the Pulse mode. This will enable Pulse users to access touchtone services. It will revert back to Pulse after hanging up.

CALL WAITING

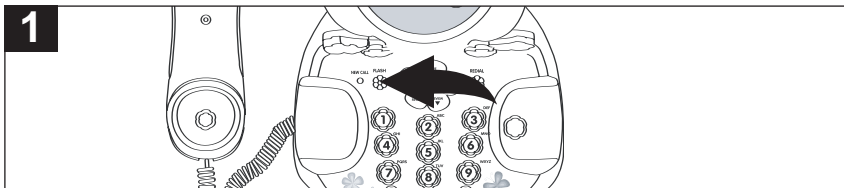

1

If you subscribe to Call Waiting through your local phone company, and you receive another phone call, simply press the FLASH button to answer the new call. Press the FLASH button again to return to the original call.

STORING AND DIALING NUMBERS IN THE SPEED-DIAL MEMORY

This telephone has ten speed-dial memories to store up to 10 of your most frequently called numbers for easy two-touch redialing. Each of the 10 memories can store numbers of up to 16 digits. HOWEVER, ONLY THE LAST 14 DIGITS WILL APPEAR IN THE DISPLAY.

IMPORTANT: You lift the handset from the cradle to store numbers in the memory. After a few seconds off the cradle, you will hear the “off the hook/hang up” warning signal from the phone company. Therefore, if you are going to store more than one number at a time, please disconnect the line cord from the wall jack to avoid the “off the hook/hang up” warning signal. REMEMBER TO RECONNECT THE LINE CORD AFTER YOU FINISH STORING YOUR NUMBERS.

See page 15 for how to store numbers and page 16 for how to dial numbers in the speed-dial memory.

OPERATION (CONTINUED)

TO STORE

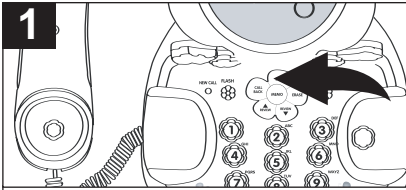

Lift the handset and press the STORE button. The "STORE" indicator will appear in the display.

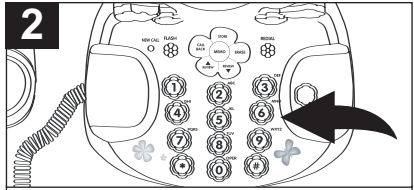

Use the Key buttons (0-9) to enter the first area code and number that you wish to store. Remember to enter the number "1" if necessary. The numbers will appear in the display as you dial them.

NOTE: If you make a mistake while entering the number, hang up or press the Hook switch to clear the display and then start with step 1 again.

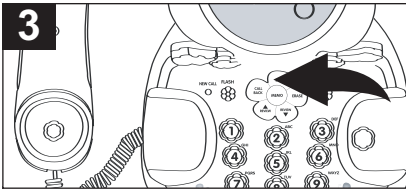

Verify that the number on the display is correct, then press the STORE button again. The Memory indicator ("MEM") will appear in the display.

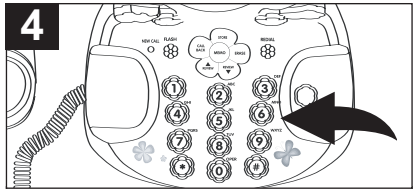

Press the number "1" button to store the displayed number in memory location 1. Repeat steps 1 through 4 to store up to nine additional numbers in memories "2" through "0"

TO CHANGE A STORED NUMBER:

To change one of the stored numbers, simply follow the procedures in steps 1 through 4 and enter a new phone number in the desired memory. The new phone number will be memorized and the previous phone number will be erased from the memory.

OPERATION (CONTINUED)

TO REDIAL A STORED NUMBER

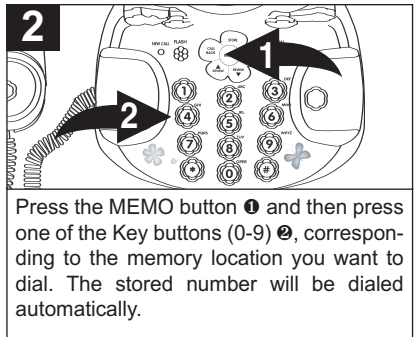
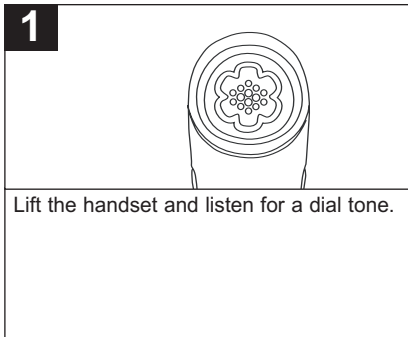

MESSAGE WAITING FUNCTION

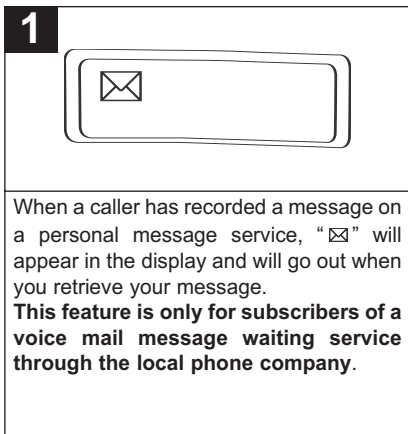

VIEWING THE CALLER ID MEMORY

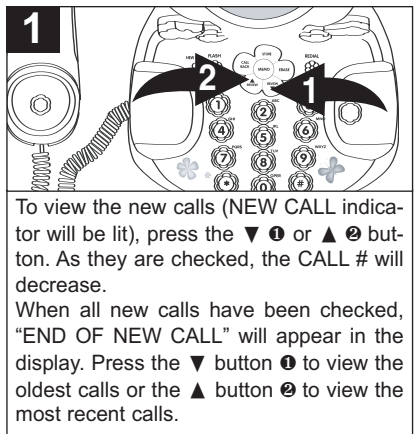

NOTES:

- After all calls are viewed, "END OF LIST" will appear in the display.
- The NEW CALL indicator will blink until all new Caller ID information has been reviewed.
- The RPT icon will appear in the display if you have received multiple new calls from the same number.
- If you receive a call from a number previously viewed in the Caller ID memory, the data in memory will be replaced with the new call's time and date, and the NEW icon will light in the display.
- If no button is pressed within 20 seconds, the display will revert to normal display and show the total call counter, new call counter, current time and date.

OPERATION (CONTINUED)

ERASING THE CALLER ID MEMORY

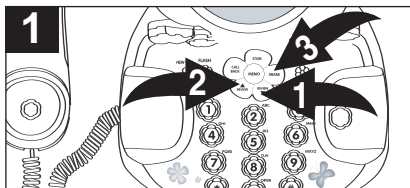

To erase a single call, press the ▼ ❶ or ▲ ❷ button to select the call to delete, then press the ERASE button ❸ twice quickly. The information for that call will be erased and the CALL # and Caller ID data will be updated.

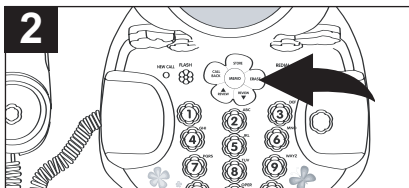

ALL NEW CALLS MUST BE REVIEWED BEFORE ERASING CALLER ID MEMORY. To erase all calls in Caller ID memory, press and hold the ERASE button for three seconds. The message "ERASE ALL CALLS" will appear in the display. Press the ERASE button again to confirm. All Caller ID information will be deleted and "NO CALLS" will appear in the display.

COPYING CALLER ID INFO TO A MEMORY PRESET

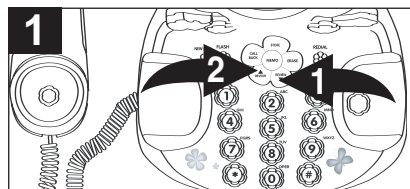

Press the ▼ ❶ or ▲ ❷ button to locate a caller ID call to be copied into a memory preset.

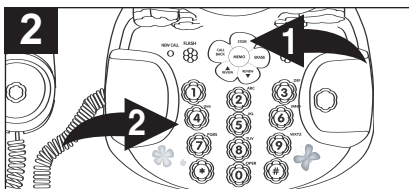

Press the STORE button ❶ twice: "MEM" will be displayed on the display. Press the Key buttons (0-9) ❷ to enter the desired memory location.

Repeat these steps for additional presets.

OPERATION (CONTINUED)

CALLING BACK A NUMBER FROM THE CALLER ID MEMORY (ON-HOOK)

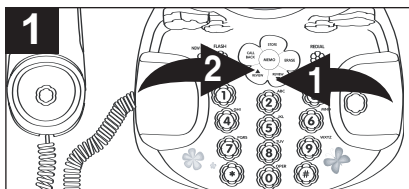

With the handset on the base, press the ▼ ❶ or ▲ ❷ button to locate a Caller ID call to be dialed.

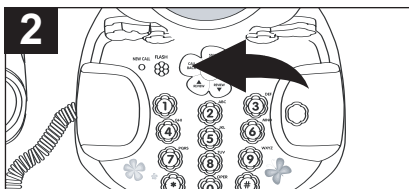

Press the CALL BACK button twice to redial; the display will show "PICK UP CALL". Pick up the handset and the number will be automatically dialed.

NOTE: If the caller's phone number is 10 digits, press the CALL BACK button once, followed by the ▼ or ▲ button to add the long distance dialing digit "1". Press the CALL BACK button again and pick up the handset to dial.

CALLING BACK A NUMBER FROM THE CALLER ID MEMORY (OFF-HOOK)

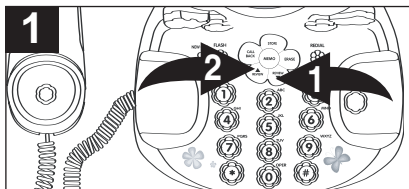

Pick up the handset and press the ▼ ❶ or ▲ ❷ button to locate a Caller ID call to be dialed.

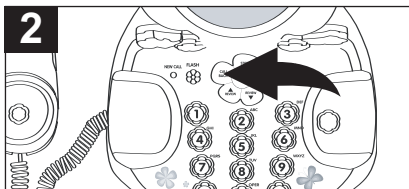

Press the CALL BACK button twice and the number will be automatically dialed.

NOTE: If the caller's phone number is 10 digits, press the CALL BACK button once, followed by the ▼ or ▲ button to add the long distance dialing digit "1". Press the CALL BACK button again and pick up the handset to dial.

OPERATION (CONTINUED)



Barbie™ has a surprise just for you! Just follow the instructions below and see what you can do with your GEMSTONE FUN button!

Step 1

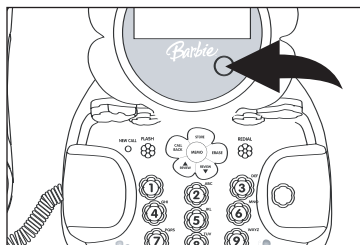

Press the GEMSTONE FUN (Sound) button on your Blossom Phone™ telephone.

Step 2



SURPRISE! With your GEMSTONE FUN button, you can hear the Barbie song!

TROUBLESHOOTING GUIDE

SYMPTOM	POSSIBLE CAUSE	POSSIBLE SOLUTION
No Dial Tone.	Line cord not connected correctly.	Connect line cord correctly.
Phone does not ring.	Ringer switch set to OFF position.	Slide Ringer switch to the HI or LO position.
	Line cord not connected correctly.	Connect line cord correctly.
	Wall jack not working.	Try phone in another wall jack.
Voice level too low.	NORM/HIGH switch set to NORM position.	Set NORM/HIGH switch to HIGH position.
Unit will not memory dial.	Memory locations not set properly.	Reprogram memory location numbers as per this manual.
	Loss of power/memory.	Check batteries or AC.
		Reprogram memories.
Unit will not dial out.	TONE/PULSE switch not set properly.	Set TONE/PULSE switch properly.
Caller ID not working	Loss of Power.	Check batteries or AC.
	You are not subscribed to Caller ID service.	Call your local phone company to subscribe.

CARE AND MAINTENANCE

1. Clean your phone with a damp (never wet) cloth. Solvent or detergent should never be used.
2. Avoid operating your unit under direct sunlight or in hot, humid or dusty places.
3. Keep your unit away from heating appliances.

EMERSON RADIO CORP.
LIMITED WARRANTY (Valid in the United States)

Emerson Radio Corp. warrants manufacturing defects in original material, including original parts and workmanship, under normal use and conditions, for a period of ninety (90) days from the date of original purchase in the U.S. With your dated proof of purchase, we will provide repair service at no charge for labor and parts at an authorized Depot Repair Facility, or replace the product in our discretion. For repair or replacement, pack your unit in a padded box, enclose your check or money order payable to Emerson Radio Corp. in the amount of \$9.00 (not required by California residents) to cover shipping and handling costs, and enclose a copy of your proof of purchase. Send your unit to:

Emerson Radio Corp.
5101 Statesman Drive
Irving, TX 75063

This warranty does not cover damage from negligence, misuse, abuse, accident, failure to follow operating instructions, commercial use, rental, repairs by an unauthorized facility, or products purchased, used, serviced or damaged outside of the United States.

THIS WARRANTY GIVES YOU SPECIFIC LEGAL RIGHTS, AND YOU MAY ALSO HAVE OTHER RIGHTS WHICH VARY FROM STATE TO STATE.

AU898M

The serial number of your system is located on a label on the bottom cabinet. Please take a moment now to locate the serial number and write the number in the space provided below. You may be asked to provide this number when calling for product service.

Model Number: **BAR550**
Serial Number: _____

 Emerson [®] SERVICE	TO FIND THE LOCATION AND PHONE NUMBER OF YOUR NEAREST SERVICE CENTER PERMITTED TO PERFORM WARRANTY...
CALL TOLL FREE: 1-800-695-0098	
FOR ADDITIONAL SET-UP OR OPERATING ASSISTANCE PLEASE CALL: 1-800-898-9020	
FOR CUSTOMER SERVICE, PLEASE WRITE TO: Emerson Radio Corp., Consumer Affairs Dept., 5101 Statesman Drive, Irving, TX 75063.	

EMERSON® WARRANTY (Valid in Canada)
Consumer Electronics, Home Appliances and Home Office Products

Thank you for choosing EMERSON®!

SYNNEX Canada Limited gives the following express warranty to the original consumer purchaser or gift recipient for this EMERSON product, when shipped in its original container and sold or distributed in Canada by SYNNEX Canada Limited or by an Authorized EMERSON Dealer:

SYNNEX Canada Limited warrants that this product is free, under normal use and maintenance, from any defects in material and workmanship. If any such defects should be found in this product within the applicable warranty period, SYNNEX Canada Limited shall, at its option, repair or replace the product as specified herein. Replacement parts furnished in connection with this warranty shall be warranted for a period equal to the unexpired portion of the original equipment warranty.

This warranty shall not apply to:

- a. Any defects caused or repairs required as a result of abusive operation, negligence, accident, improper installation or inappropriate use as outlined in the owner's manual.
- b. Any EMERSON product tampered with, modified, adjusted or repaired by any party other than SYNNEX Canada Limited or EMERSON's Authorized Service Centres.
- c. Damage caused or repairs required as a result of the use with items not specified or approved by SYNNEX Canada Limited, including but not limited to head cleaning tapes and chemical cleaning agents.
- d. Any replacement of accessories, glassware, consumable or peripheral items required through normal use of the product including but not limited to earphones, remote controls, AC adapters, batteries, temperature probe, stylus, trays, filters, cables, paper, cabinet, cabinet parts, knobs, buttons, baskets, stands, shelves, cookware and cooking utensils.
- e. Any cosmetic damage to the surface or exterior that has been defaced or caused by normal wear and tear.
- f. Any damage caused by external or environmental conditions, including but not limited to transmission line/power line voltage or liquid spillage.
- g. Any product received without appropriate model, serial number and CSA /cUL /cULus /cETL /cETLus markings.
- h. Any products used for rental or commercial purposes.
- i. Any installation, setup and/or programming charges.

Should this EMERSON product fail to operate during the warranty period, warranty service may be obtained upon delivery of the EMERSON product together with proof of purchase and a copy of this LIMITED WARRANTY statement to an Authorized EMERSON Service Centre. This warranty constitutes the entire express warranty granted by SYNNEX Canada Limited and no other dealer, service centre or their agent or employee is authorized to extend, enlarge or transfer this warranty on behalf of SYNNEX Canada Limited. To the extent the law permits, SYNNEX Canada Limited disclaims any and all liability for direct or indirect damages or losses or for any incidental, special or consequential damages or loss of profits resulting from a defect in material or workmanship relating to the product, including damages for the loss of time or use of this EMERSON product or the loss of information. The purchaser will be responsible for any removal, reinstallation, transportation and insurance costs incurred. Correction of defects, in the manner and period of time described herein, constitute complete fulfillment of all obligations and responsibilities of SYNNEX Canada Limited to the purchaser with respect to the product and shall constitute full satisfaction of all claims, whether based on contract, negligence, strict liability or otherwise.

CARRY-IN PARTS & LABOUR WARRANTY PERIODS:

- Audio Products: 1 Year (Remote Control, if applicable – 90 Days)
- Home Appliances: 1 Year
 - Microwave Magnetron parts only additional 3 Years
 - Refrigerator / Freezer Compressor parts only, additional 4 years
- Home Office Products: 1 Year

To obtain the name and address of the nearest Authorized EMERSON Service Centre or for more information on this warranty

- visit www.emersonelectronics.ca
- mail your inquiry to: SYNNEX Canada Limited, EMERSON Customer Service
200 Ronsom Drive, Toronto, ON M9W 5Z9; or
- call toll free 1-800-663-5954, Monday to Friday 9:00am – 5:00pm Eastern Standard Time.

08.2007

